

Fluidline



FORGED GATE, GLOBE & CHECK VALVES



AN ISO-9001 COMPANY

- FORGED GATE, GLOBE & CHECK VALVES

Forged Steel Compact Design Gate / Globe and Check Valves in API / ASME / BS Design Specs and ideally suited for High Pressure Temperature Services, while also proving economical for low pressure services due to their Compact Design. Easy to fit options for End connections.

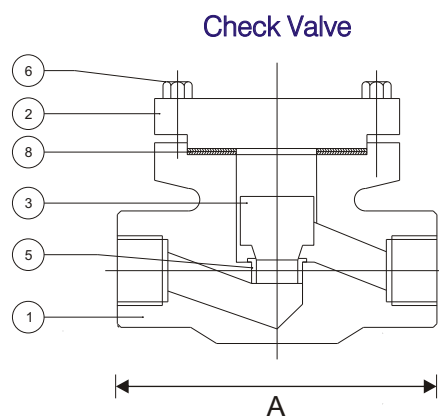
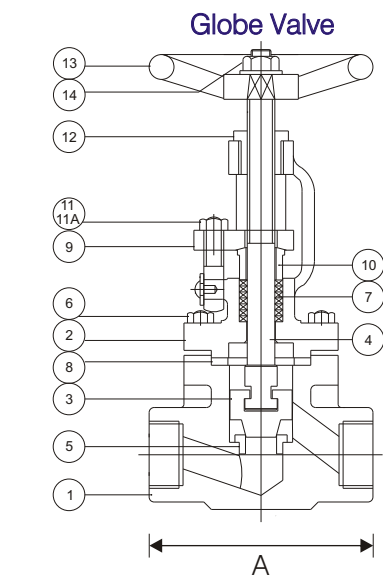
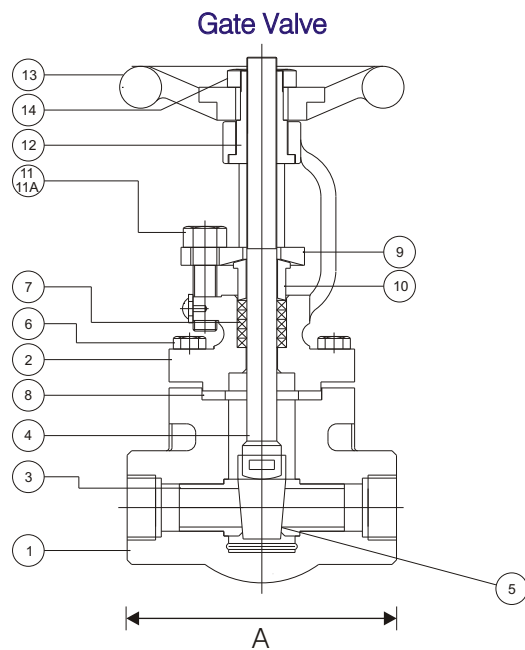

SIZE INCH / MM	A			B		C (Min.)
	800#	1500#	2500#	Screwed	Socket-weld	
1/2 15	80	90	100	13	10	21.8
3/4 20	90	100	122	13	13	27.15
1 25	100	122	140	15	13	33.4
1 1/4 32	122	140	--	16	13	42.6
1 1/2 40	122	140	--	16	13	48.7
2 50	140	--	--	19	16	61.20

CLASS #	TEST PRESSURES		
	HYDRAULIC BODY Kg/Cm ² (PSIG)	HYDRAULIC SEAT / BACK SEAT Kg/Cm ² (PSIG)	SEAT AIR Kg/Cm ² (PSIG)
800	211 (3000)	148 (2000)	6 (80)
1500	392 (5580)	287 (4080)	6 (80)
2500	621 (8830)	456 (6500)	6 (80)

• MFG. STD.	- FOR GATE VALVES : API 602 - FOR GLOBE & CHECK VALVES : BS 5352
• INSPECTION STD.	BS 6755 / API 598
• PRESSURE RATING	ANSI B 16.34
END CONNECTION	
• SCREWED (NPT)	ANSI B 20.1
• SCREWED (BSP)	BS 21
• SOCKET - WELD	ANSI B 16.11
• BUTT WELD	ANSI B 16.25

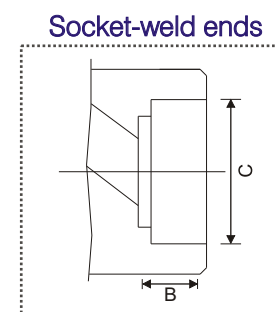
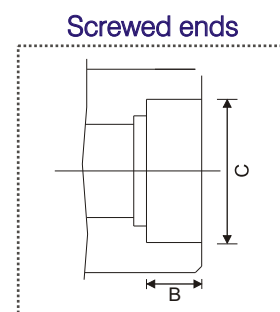



STANDARD MATERIALS FOR FORGED GATE, GLOBE & CHECK VALVES

PART NO.	ITEM	CARBON STEEL	HIGH TEMPERATURE STEEL	STAINLESS STEEL
1	BODY	ASTM A 105	ASTM A 182 GR F 22	ASTM A 182 GR F 316
2	BONNET / COVER	ASTM A 105	ASTM A 182 GR F 22	ASTM A 182 GR F 316
3	WEDGE/DISC	ASTM A 182 F 6	ASTM A 182 GR F 6	ASTM A 182 GR F 316
3A	SPINDLE NUT	ASTM A 276 TP 410	ASTM A 276 TP 410	ASTM A 276 TP 316
4	SPINDLE / PIN	ASTM A 276 TP 410	ASTM A 276 TP 410	ASTM A 276 TP 316
'O' 5	SEAT RINGS	13%CR./STELLITED	HF WITH STELLITE6	INTEGRAL
6	HEX-BOLT	ASTM A 193 GR.B7	ASTM A 193 GR.B7	ASTM A 193 GR.B8
'O' 7	GLAND PACKING	GRAPHITED ASBESTOS	GRAPHITED ASBESTOS	PTFE / BRAIDED
		(+) 2 GRAPHITE RINGS	(+) 2 GRAPHITE RINGS	GRAPHITE RINGS PTFE
'O' 8	GASKET	REFER CHART BELOW		
9	GLAND FLANGE	ASTM A 105	ASTM A 105	STAINLESS STEEL GR.316
10	GLAND	ASTM A 276 T 410	ASTM A 276 T 410	ASIM A276 T316
11 / 11A	EYE BOLT / NUT	ASTM A 307 GR. B	ASTM A 307 GR. B	ASTM A 307 GR. B
'O' 12	YOKE SLEEVE / NUT	AISI 4140 / ASTM A 439 D2	AISI 4140 / ASTM A 439 D2	AISI 4140 / ASTM A 439 D2
'O' 13	HAND WHEEL	CAST IRON	CARBON STEEL	CARBON STEEL
14	HAND WHEEL NUT	CARBON STEEL	CARBON STEEL	CARBON STEEL

BONNET GASKET OPTIONS

800# : S.S. 316 SPIRAL WOUND WITH GRAPHITE/P.T.F.E. FILLER
 900# / 1500# / 2500# : SEAL-WELDED / S.S. 316 SPIRAL WOUND WITH GRAPHITE FILLER

ALTERNATE MATERIAL GRADES:

ALLOY STEEL : F 11
 STAINLESS STEEL : F 304, F 304L, F 316L

* Items marked as 'O' are available as operational spares.

* Available with IBR form IIIC certificates.

Due to constant changes and advancements in standards and technology, We reserved our right to make changes in technical and dimensional details without prior notice.





AN API 600 LICENSEE

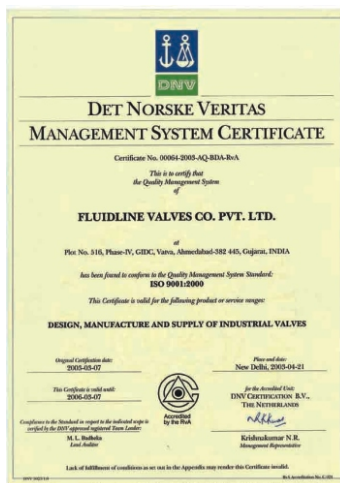

ISO-9001 CERTIFIED

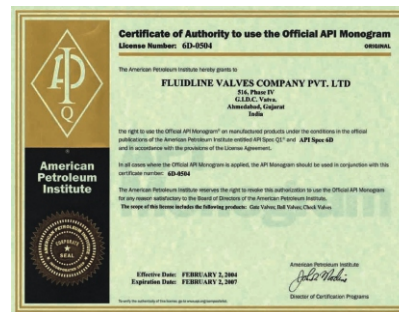

AN API 6D LICENSEE

OUR OTHER PRODUCTS :

- GATE GLOBE AND CHECK VALVES
- BALL VALVES
- PIPELINE STRAINERS
- SPECIAL SERVICE VALVES
- CAST IRON VALVES FOR WATER WORKS
[GATE (SLUICE), GLOBE AND CHECK VALVES]
- DUAL PLATE CHECK VALVES
- BUTTERFLY VALVES



Fluidline

Valves Company Private Limited

Head Office : 401-A, Poonam Chambers,
115, Dr. Annie Besant Road,
Worli, Mumbai - 400 018.
Tel. : 2494 4057 / 58 Fax : 022-2494 4059
E-mail : fluidline@hathway.com
Website : www.fluidlinevalves.com

Dealer / Representative :

generalgr@gmail.com
Tel. +91-22- 5655 8455

Jan, 2006



Fluidline